

**FEATURES**

- ※ Compact size 6x6mm
- ※ Sharp tactile feeling
- ※ Cap options

**APPLICATION**

- ※ Audio, OA equipment
- ※ Instrumentation
- ※ Industrial

**SPECIFICATION**

Contact Rating	50mA, 12V DC
Contact Resistance	100mΩ max.
Insulation Resistance	100MΩ min. 500V DC
Dielectric Strength	250V AC/1 minute
Operating Force	70±30gf, Blue(U) 100±50gf, Black(K) 160±50gf, Brown(N) 260±50gf, Red(R) 320±80gf, Salmon(S) 520±130gf, Yellow(Y)
Travel	0.25mm
Operating Life	Phosphor Bronze Dome 50,000 cycles for 520/320gf 100,000 cycles for 260gf 200,000 cycles for 160/100/70gf Stainless Steel Dome 300,000 cycles for 520/320gf 500,000 cycles for 260gf 1,000,000 cycles for 160/100/70gf
Operating Temp.	-25°C ~ +70°C
Storage Temp.	-30°C ~ +80°C

**HOW TO ORDER**

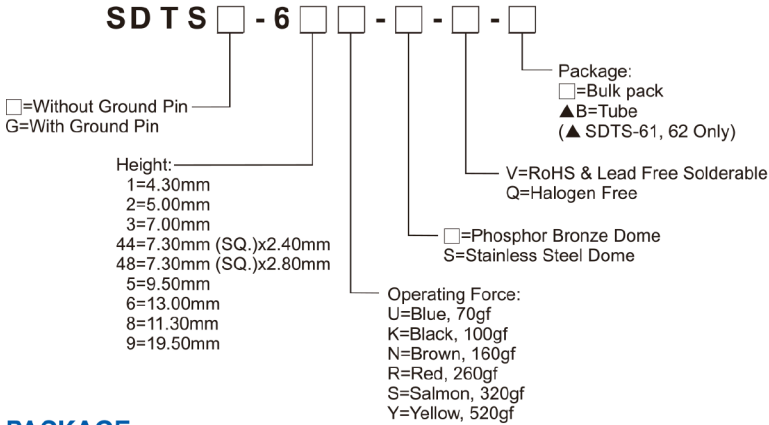

**PACKAGE**

- <Bag>  
1000 pcs
- <Tub>  
SDTS-61/62: 75 pcs

**CIRCUIT**

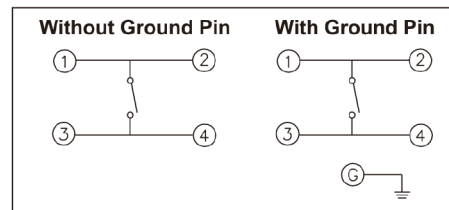

TACT SWITCH

**SDTS-6**

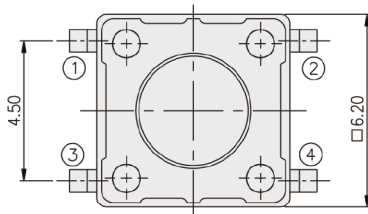

PART NO.	H
SDTS-61	4.30
SDTS-62	5.00
SDTS-63	7.00
SDTS-65	9.50
SDTS-66	13.00
SDTS-68	11.30
SDTS-69	19.50

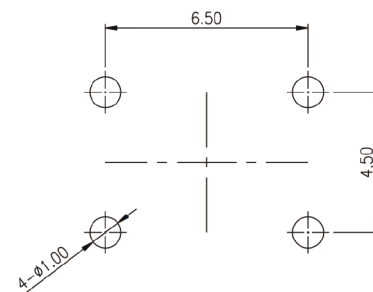
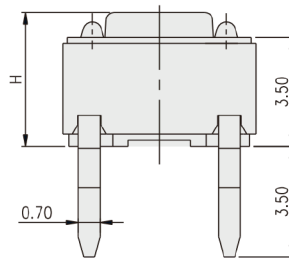
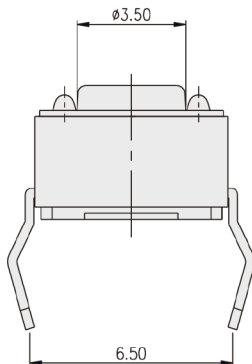

P.C.B. LAYOUT

TACT SWITCH  
SDTS(G)-6 SERIES

6x6 Through Hole  
& Ground Terminal Type



SDTS-644(8)

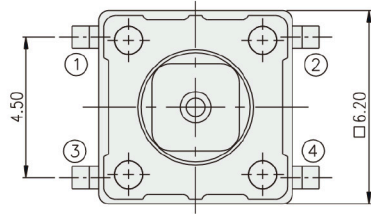

PART NO.	□A	□B
SDTS-644	2.40	1.60
SDTS-648	2.80	2.00

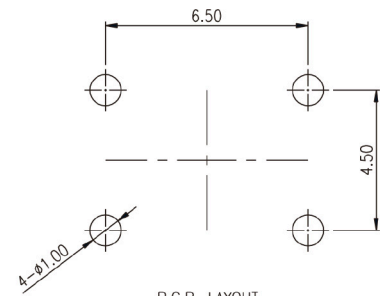
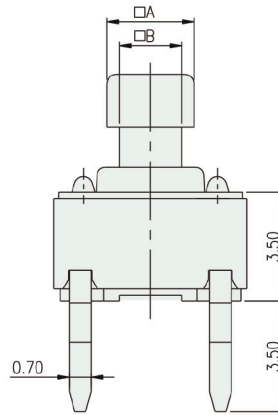
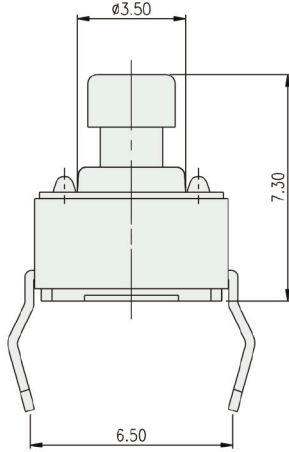

P.C.B. LAYOUT

TACT SWITCH

SDTSG-6

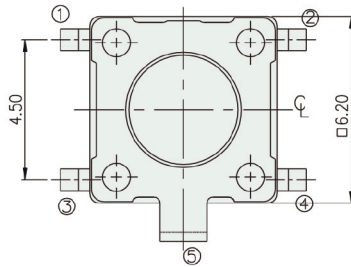

PART NO.	H
SDTSG-61	4.30
SDTSG-62	5.00
SDTSG-63	7.00
SDTSG-65	9.50
SDTSG-66	13.00
SDTSG-68	11.30
SDTSG-69	19.50

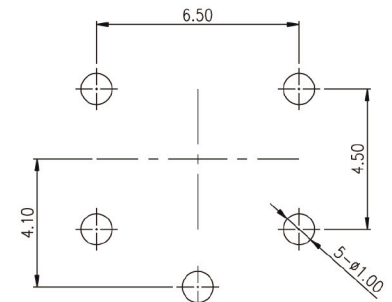
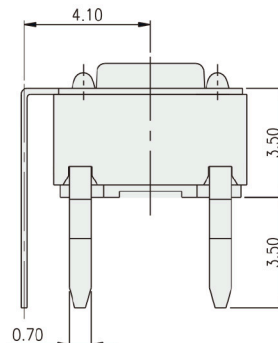
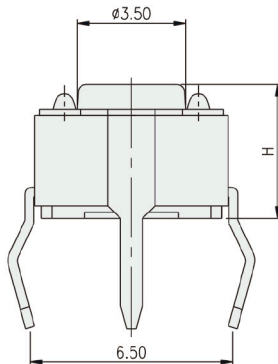

P.C.B. LAYOUT