

**FEATURES**

- ※ Sealed
- ※ Reflow solderable
- ※ Dust proof with high reliability

**APPLICATION**

- ※ Audio, OA equipment
- ※ Instrumentation, Communication
- ※ White goods

**SPECIFICATION**

Contact Rating	50mA, 12V DC
Contact Resistance	100mΩ max.
Insulation Resistance	100MΩ min. 500V DC
Dielectric Strength	250V AC/1 minute
Operating Force	160±50gf, Brown(N) 66/677 160±50gf, Silver(S) 68 180±50gf, Brown(N) 69/67/65/64 260±70gf, Red(R) 69/67/66/65/64 360±90gf, Transparent(T) 69/67/65/677
Travel	0.25mm 68S/66N/66R/677 0.45mm (69/67N,R)/(65/64N,R,T) 0.6mm 69/67T
Operating Life	100,000 cycles min. for 68/66/677 500,000 cycles min. for 69/67/65/64
Operating Temp.	-25°C ~ +70°C
Storage Temp.	-30°C ~ +80°C

**HOW TO ORDER**

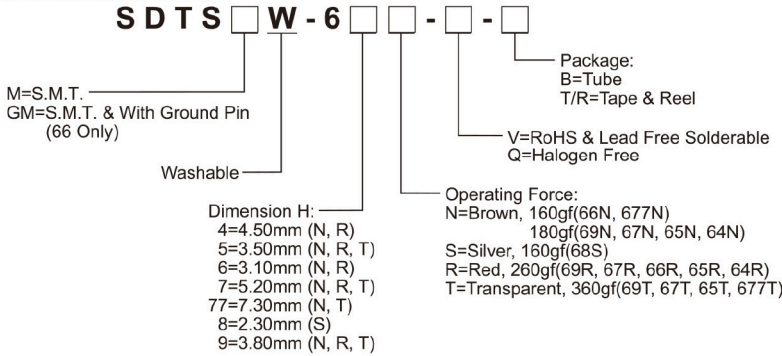

**CIRCUIT**

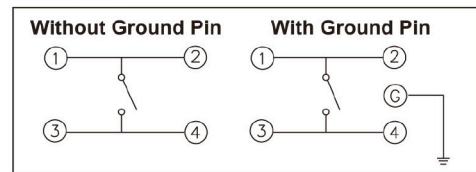

**PACKAGE**

- <Tube>  
75 pcs
- <Tape & Reel>  
SDTSGMW-66: 2000 pcs  
SDTSMW-68, 66: 2000 pcs  
SDTSMW-69, 65: 1900 pcs  
SDTSMW-67, 64: 900 pcs  
SDTSMW-677: 650 pcs

TACT SWITCH

**SDTSGMW-66**

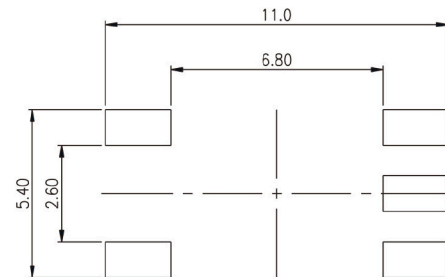
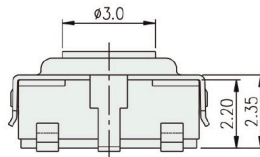
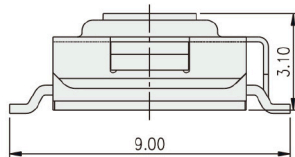
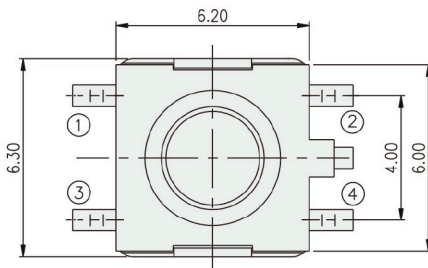

P.C.B. LAYOUT

TACT SWITCH  
**SDTS(G)MW-6 SERIES**

6x6 Gull-Wing SMT  
 Washable Type



**SDTSMW-68**

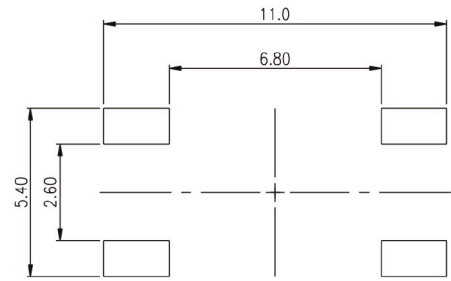
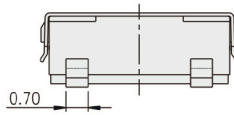
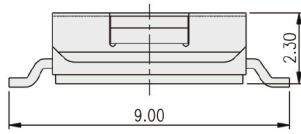
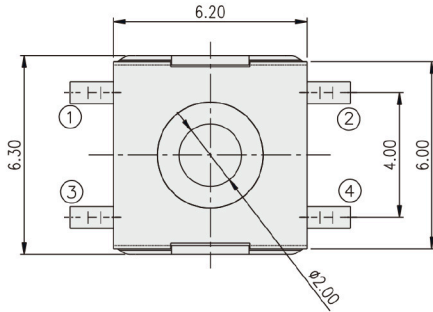

P.C.B. LAYOUT

TACT SWITCH

**SDTSMW-6**

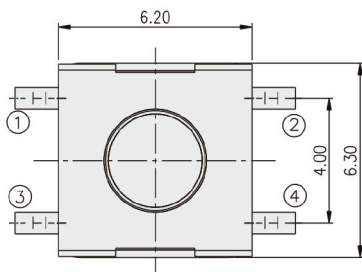

PART NO.	H
SDTSMW-64	4.50
SDTSMW-65	3.50
SDTSMW-67	5.20
SDTSMW-69	3.80
SDTSMW-677	7.30

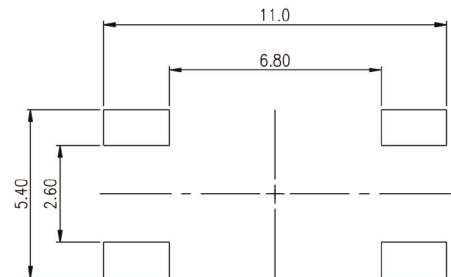
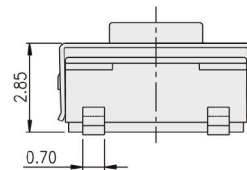
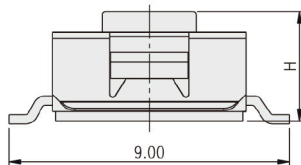

P.C.B. LAYOUT