

## RLD Series

### Features

- 105°C, 12,000 hours assured
- 10 φ ~ 18 φ with large permissible ripple current
- Suitable for switching power supplies, UPS, Ballast
- Smaller case size current
- RoHS compliance

### Specifications

Items	Performance																												
Category Temperature Range	160 ~ 400V	450V																											
	-40°C ~ +105°C	-25°C ~ +105°C																											
Capacitance Tolerance	±20% (at 120 Hz, 20°C)																												
Leakage Current (at 20°C)	<table border="1"> <thead> <tr> <th>Time</th> <th colspan="2">after 5 minutes</th> </tr> </thead> <tbody> <tr> <td rowspan="2">Leakage Current</td> <td>CV ≤ 1,000</td> <td>CV &gt; 1,000</td> </tr> <tr> <td>I = 0.03CV + 15(μA)</td> <td>I = 0.02CV + 25(μA)</td> </tr> </tbody> </table>		Time	after 5 minutes		Leakage Current	CV ≤ 1,000	CV > 1,000	I = 0.03CV + 15(μA)	I = 0.02CV + 25(μA)																			
	Time	after 5 minutes																											
Leakage Current	CV ≤ 1,000	CV > 1,000																											
	I = 0.03CV + 15(μA)	I = 0.02CV + 25(μA)																											
Where, C = rated capacitance in μF, V = rated DC working voltage in V																													
Tanδ (at 120 Hz, 20°C)	<table border="1"> <thead> <tr> <th>Rated Voltage</th> <th>160</th> <th>200</th> <th>250</th> <th>350</th> <th>400</th> <th>450</th> </tr> </thead> <tbody> <tr> <td>Tanδ (max)</td> <td>0.20</td> <td>0.20</td> <td>0.20</td> <td>0.24</td> <td>0.24</td> <td>0.24</td> </tr> </tbody> </table>						Rated Voltage	160	200	250	350	400	450	Tanδ (max)	0.20	0.20	0.20	0.24	0.24	0.24									
	Rated Voltage	160	200	250	350	400	450																						
Tanδ (max)	0.20	0.20	0.20	0.24	0.24	0.24																							
Low Temperature Characteristics (at 120 Hz)	Impedance ratio shall not exceed the values given in the table below.																												
	<table border="1"> <thead> <tr> <th colspan="2">Rated Voltage</th> <th>160</th> <th>200</th> <th>250</th> <th>350</th> <th>400</th> <th>450</th> </tr> </thead> <tbody> <tr> <td rowspan="2">Impedance Ratio</td> <td>Z(-25°C)/Z(+20°C)</td> <td>3</td> <td>3</td> <td>3</td> <td>5</td> <td>5</td> <td>6</td> </tr> <tr> <td>Z(-40°C)/Z(+20°C)</td> <td>6</td> <td>6</td> <td>6</td> <td>6</td> <td>6</td> <td>-</td> </tr> </tbody> </table>							Rated Voltage		160	200	250	350	400	450	Impedance Ratio	Z(-25°C)/Z(+20°C)	3	3	3	5	5	6	Z(-40°C)/Z(+20°C)	6	6	6	6	6
Rated Voltage		160	200	250	350	400	450																						
Impedance Ratio	Z(-25°C)/Z(+20°C)	3	3	3	5	5	6																						
	Z(-40°C)/Z(+20°C)	6	6	6	6	6	-																						
Endurance	<table border="1"> <thead> <tr> <th>Test Time</th> <th>12,000 Hrs</th> </tr> </thead> <tbody> <tr> <td>Capacitance Change</td> <td>Within ±20% of initial value</td> </tr> <tr> <td>Tanδ</td> <td>Less than 200% of specified value</td> </tr> <tr> <td>Leakage Current</td> <td>Within specified value</td> </tr> </tbody> </table>						Test Time	12,000 Hrs	Capacitance Change	Within ±20% of initial value	Tanδ	Less than 200% of specified value	Leakage Current	Within specified value															
	Test Time	12,000 Hrs																											
Capacitance Change	Within ±20% of initial value																												
Tanδ	Less than 200% of specified value																												
Leakage Current	Within specified value																												
* The above specifications shall be satisfied when the capacitors are restored to 20°C after the rated voltage applied with rated ripple current for 12,000 hours at 105°C.																													
Shelf Life Test	<table border="1"> <thead> <tr> <th>Test Time</th> <th>1,000 Hrs</th> </tr> </thead> <tbody> <tr> <td>Capacitance Change</td> <td>Within ±20% of initial value</td> </tr> <tr> <td>Tanδ</td> <td>Less than 200% of specified value</td> </tr> <tr> <td>Leakage Current</td> <td>Less than 500% of specified value</td> </tr> </tbody> </table>						Test Time	1,000 Hrs	Capacitance Change	Within ±20% of initial value	Tanδ	Less than 200% of specified value	Leakage Current	Less than 500% of specified value															
	Test Time	1,000 Hrs																											
Capacitance Change	Within ±20% of initial value																												
Tanδ	Less than 200% of specified value																												
Leakage Current	Less than 500% of specified value																												
* The above specifications shall be satisfied when the capacitors are restored to 20°C after exposing them for 1,000 hours at 105°C without voltage applied. The rated voltage shall be applied to the capacitors before the measurements (Refer to JIS C 5101-4 4.1).																													
Ripple Current and Frequency Multipliers	<table border="1"> <thead> <tr> <th>Cap. (μF)</th> <th colspan="4">Frequency (Hz)</th> </tr> <tr> <th></th> <th>120</th> <th>1k</th> <th>10k</th> <th>100k up</th> </tr> </thead> <tbody> <tr> <td>15 ~ 82</td> <td>1.00</td> <td>1.75</td> <td>2.25</td> <td>2.50</td> </tr> <tr> <td>100 ≤</td> <td>1.00</td> <td>1.67</td> <td>2.05</td> <td>2.25</td> </tr> </tbody> </table>					Cap. (μF)	Frequency (Hz)					120	1k	10k	100k up	15 ~ 82	1.00	1.75	2.25	2.50	100 ≤	1.00	1.67	2.05	2.25				
	Cap. (μF)	Frequency (Hz)																											
	120	1k	10k	100k up																									
15 ~ 82	1.00	1.75	2.25	2.50																									
100 ≤	1.00	1.67	2.05	2.25																									

### Diagram of Dimensions

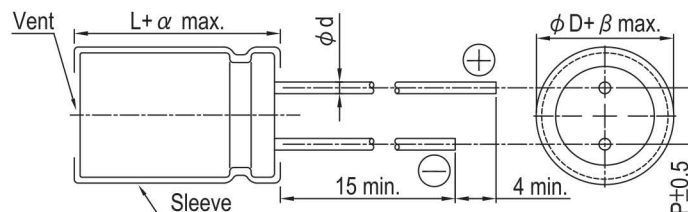

Lead Spacing and Diameter Unit: mm

	10	12.5	16	18
φD	10	12.5	16	18
P	5.0	5.0	7.5	7.5
φd	0.6		0.8	
α	2.0			
β	0.5			

### Dimension and Permissible Ripple Current

Dimension:  $\phi D \times L$ (mm)  
Ripple Current: mA/rms at 105°C

Cap. (μF)	160V (2C)			200V (2D)			250V (2E)			350V (2V)			400V (2G)		
	$\phi D \times L$	Ripple Current		$\phi D \times L$	Ripple Current		$\phi D \times L$	Ripple Current		$\phi D \times L$	Ripple Current		$\phi D \times L$	Ripple Current	
		120 Hz	100k Hz		120 Hz	100k Hz		120 Hz	100k Hz		120 Hz	100k Hz		120 Hz	100k Hz
22													10×25	215	538
27										10×25	240	600	10×35	270	675
33										10×35	300	750	10×40	310	775
47							10×25	315	788	12.5×30	450	1,125	12.5×25	355	888
56				10×25	345	863	12.5×25	460	1,150	10×45	385	963	10×50	400	1,000
68	10×25	375	938	10×35	425	1,063	12.5×25	510	1,275	12.5×40	595	1,488	12.5×40	540	1,350
82	10×30	445	1,113	12.5×25	565	1,413	10×45	515	1,288	16×25	565	1,413	18×25	580	1,450
100	10×35	520	1,170	10×45	565	1,271	12.5×30	590	1,475	12.5×35	625	1,613	12.5×45	620	1,550
120	10×40	595	1,339	12.5×30	660	1,485	10×50	585	1,316	12.5×40	795	1,789	16×45	785	1,766
150	10×50	715	1,609	12.5×35	765	1,721	12.5×35	700	1,575	16×25	755	1,699	18×35.5	790	1,778
180	16×25	920	2,070	16×25	840	1,890	12.5×45	920	2,070	18×31.5	670	1,675	16×40	880	1,980
220	16×31.5	1,100	2,475	16×25	995	2,239	18×25	950	2,138	18×25	865	1,946	18×40	985	2,216
270	18×25	1,050	2,363	18×25	950	2,138	16×35.5	1,015	2,284	18×45	1,090	2,453	18×45	1,000	2,250
330	16×35.5	1,240	2,790	18×31.5	1,135	2,554	16×40	1,160	2,610	18×50	1,220	2,745			
390	18×31.5	1,255	2,824	18×31.5	1,135	2,554	18×31.5	1,135	2,554						
470	16×40	1,420	3,195	16×40	1,280	2,880	16×50	1,330	2,993						
560	18×35.5	1,435	3,229	18×35.5	1,300	2,925	18×40	1,320	2,970						
	16×45	1,575	3,544	16×50	1,470	3,308	18×45	1,485	3,341						
	18×40	1,590	3,578	18×40	1,510	3,398	18×50	1,625	3,656						
	16×50	1,760	3,960												
	18×45	1,770	3,983												
	18×50	1,945	4,376												

Cap. (μF)	450V (2W)		
	$\phi D \times L$	Ripple Current	
		120 Hz	100k Hz
15	10×25	185	463
22	10×35	250	625
27	10×40	290	725
33	12.5×25	340	850
47	12.5×30	400	1,000
56	12.5×40	525	1,313
68	16×25	500	1,250
82	12.5×50	605	1,513
100	16×31.5	585	1,463
120	16×35.5	660	1,650
	18×31.5	660	1,650
	16×45	760	1,900
	18×35.5	755	1,888
	16×50	855	1,924
	18×40	845	1,901
	18×45	945	2,126

### Part Numbering System

RLD Series    15 μF    ±20%    450V    Bulk Package    Flat Type    10  $\phi$  ×25L    Pb-free and PET sleeve

**RLD**    **150**    **M**    **2W**    **BK**    **F**    **1025**    **S**

Series Name    Capacitance    Capacitance Tolerance    Rated Voltage    Lead Configuration and Package    Rubber Type    Case Size    Lead Wire and Sleeve type

Note: For more details, please refer to "Part Numbering System (Radial Type)" on page 13.

Radial