

TACT SWITCH

SDTSJW()-6 SERIES

6x6 J SMT
Washable Type

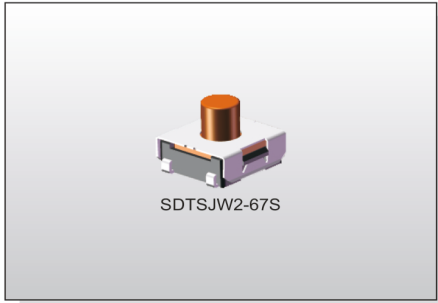

FEATURES

- ※Sealed
- ※Gold contact available
- ※Dust proof with high reliability

APPLICATION

- ※Audio, OA equipment
- ※Instrumentation, Communication
- ※White goods

SPECIFICATION

Contact Rating	50mA, 12V DC
Contact Resistance	100mΩ max.
Insulation Resistance	100MΩ min. 500V DC
Dielectric Strength	250V AC/1 minute
Operating Force	200±50gf, 400±100gf
Travel	0.4/0.6mm
Operating Life	300, 000 cycles
Operating Temp.	-40°C ~ +85°C
Storage Temp.	-40°C ~ +85°C

HOW TO ORDER

SDTSJW□-6□□-Q-□

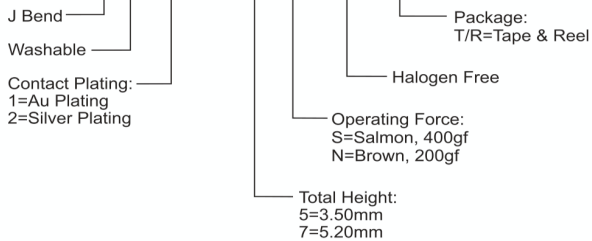

CIRCUIT

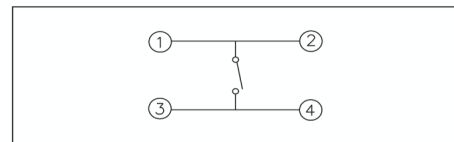

PACKAGE

<Tape & Reel>
SDTSJW□-65: 1900 pcs
SDTSJW□-67: 900 pcs

TACT SWITCH

SDTSJW□-6

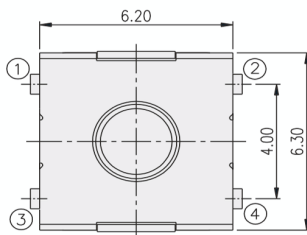

PART NO.	H
SDTSJW□-65	3.50
SDTSJW□-67	5.20

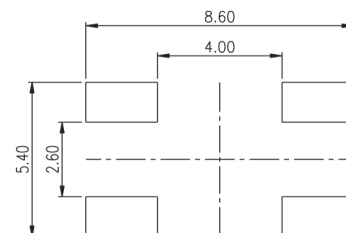
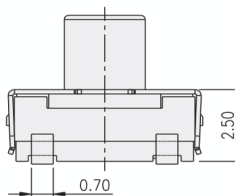
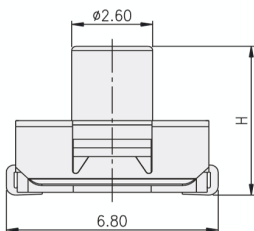

P.C.B. LAYOUT