

Features

- Snap-in terminal type
- 85°C, 2,000 hours assured
- Good safe characteristics which shall be failed with open mode without sparking and catching fire, when it is applied excess voltage
- RoHS compliance



Specifications

Items	Performance																					
Category	200 ~ 400V		450V																			
Temperature Range	-40°C ~ +85°C		-25°C ~ +85°C																			
Capacitance Tolerance	±20% (at 120 Hz, 20°C)																					
Leakage Current (at 20°C)	I = 3√CV or 1.5 mA whichever is smaller (after 5 minutes) Where, C = rated capacitance in μF, V = rated DC Rated Voltage in V																					
Tanδ (at 120 Hz, 20°C)	<table><tr><td>Rated Voltage</td><td>200</td><td>250</td><td>400</td><td>450</td></tr><tr><td>Tanδ (max)</td><td>0.15</td><td>0.15</td><td>0.20</td><td>0.20</td></tr></table>					Rated Voltage	200	250	400	450	Tanδ (max)	0.15	0.15	0.20	0.20							
Rated Voltage	200	250	400	450																		
Tanδ (max)	0.15	0.15	0.20	0.20																		
Low Temperature Characteristics (at 120 Hz)	Impedance ratio shall not exceed the values given in the table below. <table><tr><td colspan="2">Rated Voltage</td><td>200</td><td>250</td><td>400</td><td>450</td></tr><tr><td rowspan="2">Impedance Ratio</td><td>Z(-25°C)/Z(+20°C)</td><td>4</td><td>4</td><td>8</td><td>8</td></tr><tr><td>Z(-40°C)/Z(+20°C)</td><td>8</td><td>10</td><td>18</td><td>-</td></tr></table>					Rated Voltage		200	250	400	450	Impedance Ratio	Z(-25°C)/Z(+20°C)	4	4	8	8	Z(-40°C)/Z(+20°C)	8	10	18	-
Rated Voltage		200	250	400	450																	
Impedance Ratio	Z(-25°C)/Z(+20°C)	4	4	8	8																	
	Z(-40°C)/Z(+20°C)	8	10	18	-																	
Endurance	<table><tr><td>Test Time</td><td>2,000 Hrs</td></tr><tr><td>Capacitance Change</td><td>Within ±20% of initial value</td></tr><tr><td>Tanδ</td><td>Less than 200% of specified value</td></tr><tr><td>Leakage Current</td><td>Within specified value</td></tr></table> <p>* The above specifications shall be satisfied when the capacitors are restored to 20°C after the rated voltage applied with rated ripple current for 2,000 hours at 85°C.</p>					Test Time	2,000 Hrs	Capacitance Change	Within ±20% of initial value	Tanδ	Less than 200% of specified value	Leakage Current	Within specified value									
Test Time	2,000 Hrs																					
Capacitance Change	Within ±20% of initial value																					
Tanδ	Less than 200% of specified value																					
Leakage Current	Within specified value																					
Shelf Life Test	<table><tr><td>Test Time</td><td>1,000 Hrs</td></tr><tr><td>Capacitance Change</td><td>Within ±20% of initial value</td></tr><tr><td>Tanδ</td><td>Less than 150% of specified value</td></tr><tr><td>Leakage Current</td><td>Within specified value</td></tr></table> <p>* The above specifications shall be satisfied when the capacitors are restored to 20°C after exposing them for 1,000 hours at 85 °C without voltage applied. The rated voltage shall be applied to the capacitors before the measurements (Refer to JIS C 5101-4 4.1).</p>					Test Time	1,000 Hrs	Capacitance Change	Within ±20% of initial value	Tanδ	Less than 150% of specified value	Leakage Current	Within specified value									
Test Time	1,000 Hrs																					
Capacitance Change	Within ±20% of initial value																					
Tanδ	Less than 150% of specified value																					
Leakage Current	Within specified value																					
Ripple Current and Frequency Multipliers	<table><tr><td>Frequency (Hz)</td><td>50 / 60</td><td>100 / 120</td><td>300</td><td>1k</td><td>10k up</td></tr><tr><td>Multiplier</td><td>0.8</td><td>1.0</td><td>1.1</td><td>1.3</td><td>1.4</td></tr></table>					Frequency (Hz)	50 / 60	100 / 120	300	1k	10k up	Multiplier	0.8	1.0	1.1	1.3	1.4					
Frequency (Hz)	50 / 60	100 / 120	300	1k	10k up																	
Multiplier	0.8	1.0	1.1	1.3	1.4																	
Safety Function Test Conditions	1. DC reverse voltage test: The capacitor is shall be connected in reverse polarity, and applied under specified Rated Voltage. 2. DC over voltage test: The voltage of 1.2 times shall be applied to the capacitor.																					
Failure percentage Failure rate	When the failure percentage / failure rate is required, please contact with us for further discussion.																					

Diagram of Dimensions

Unit: mm

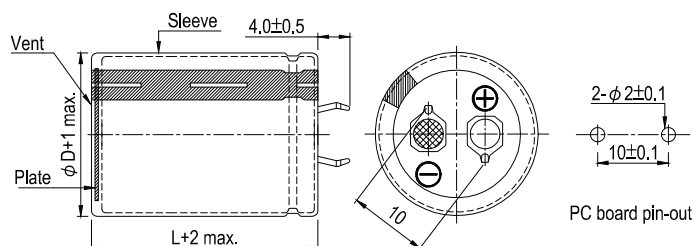

Dimension and Permissible Ripple Current

Rated Voltage V _{DC}	Capacitance 120 Hz, 20°C μF	φ D×L mm	Ripple Current 120 Hz, 85°C A/rms	Tan δ at 120 Hz, 20°C	ESR 120 Hz, 20°C Ω	LC 5 minutes mA	Part Number
200	560	35 × 20	2.08	0.15	0.355	1.00	LS2561M2D--A3520
	680	35 × 20	2.23	0.15	0.293	1.11	LS2681M2D--A3520
	680	35 × 25	2.30	0.15	0.293	1.11	LS2681M2D--A3525
	820	35 × 25	2.53	0.15	0.243	1.21	LS2821M2D--A3525
	1,000	35 × 30	2.96	0.15	0.199	1.34	LS2102M2D--A3530
	1,200	35 × 35	3.40	0.15	0.166	1.47	LS2122M2D--A3535
	1,500	35 × 40	3.87	0.15	0.133	1.50	LS2152M2D--A3540
	1,800	35 × 45	4.37	0.15	0.111	1.50	LS2182M2D--A3545
250	390	35 × 20	1.68	0.15	0.510	0.94	LS2391M2E--A3520
	470	35 × 20	1.85	0.15	0.423	1.03	LS2471M2E--A3520
	470	35 × 25	2.01	0.15	0.423	1.03	LS2471M2E--A3525
	560	35 × 25	2.21	0.15	0.355	1.12	LS2561M2E--A3525
	680	35 × 30	2.54	0.15	0.293	1.24	LS2681M2E--A3530
	820	35 × 35	2.90	0.15	0.243	1.36	LS2821M2E--A3535
	1,000	35 × 35	3.21	0.15	0.199	1.50	LS2102M2E--A3535
	1,200	35 × 40	3.56	0.15	0.166	1.50	LS2122M2E--A3540
400	1,500	35 × 50	4.26	0.15	0.133	1.50	LS2152M2E--A3550
	220	35 × 25	1.60	0.20	1.206	0.89	LS2221M2G--A3525
	270	35 × 30	1.75	0.20	0.983	0.99	LS2271M2G--A3530
	330	35 × 30	1.95	0.20	0.804	1.09	LS2331M2G--A3530
	390	35 × 35	2.17	0.20	0.680	1.18	LS2391M2G--A3535
	470	35 × 40	2.42	0.20	0.565	1.30	LS2471M2G--A3540
450	560	35 × 45	2.71	0.20	0.474	1.42	LS2561M2G--A3545
	120	35 × 20	1.11	0.20	2.212	0.70	LS2121M2W--A3520
	150	35 × 20	1.24	0.20	1.769	0.78	LS2151M2W--A3520
	150	35 × 25	1.35	0.20	1.769	0.78	LS2151M2W--A3525
	180	35 × 25	1.39	0.20	1.474	0.85	LS2181M2W--A3525
	220	35 × 30	1.61	0.20	1.206	0.94	LS2221M2W--A3530
	270	35 × 35	1.86	0.20	0.983	1.05	LS2271M2W--A3535
	330	35 × 35	2.06	0.20	0.804	1.16	LS2331M2W--A3535
	390	35 × 45	2.34	0.20	0.680	1.26	LS2391M2W--A3545
	470	35 × 50	2.63	0.20	0.565	1.38	LS2471M2W--A3550

Part Numbering System

LS2 Series 220μF ±20% 400V 4.0±0.5mm 35 φ ×25L

LS2

Series Name

221

Capacitance

Example:

Cap.	Symbol
56	560
220	221
470	471

M

Capacitance tolerance

M = ±20%
K = ±10%

2G

Rated voltage

Example:

Voltage	Symbol
400	2G
450	2W

--

Terminal type

Example:

Type	Symbol
2 pins	--
5 pins	L5

A

Terminal length

"A":
6.3±1.0 mm

3525

Case size

Example:

φ D×L	Code
22×30	2230
25×25	2525
30×40	3040

xx

S = Standard
KS = AEC-Q200 Qualified,
Safety Critical Application
LS = AEC-Q200 Qualified,
Non-Safety Critical
Application

Typical Endurance Curves

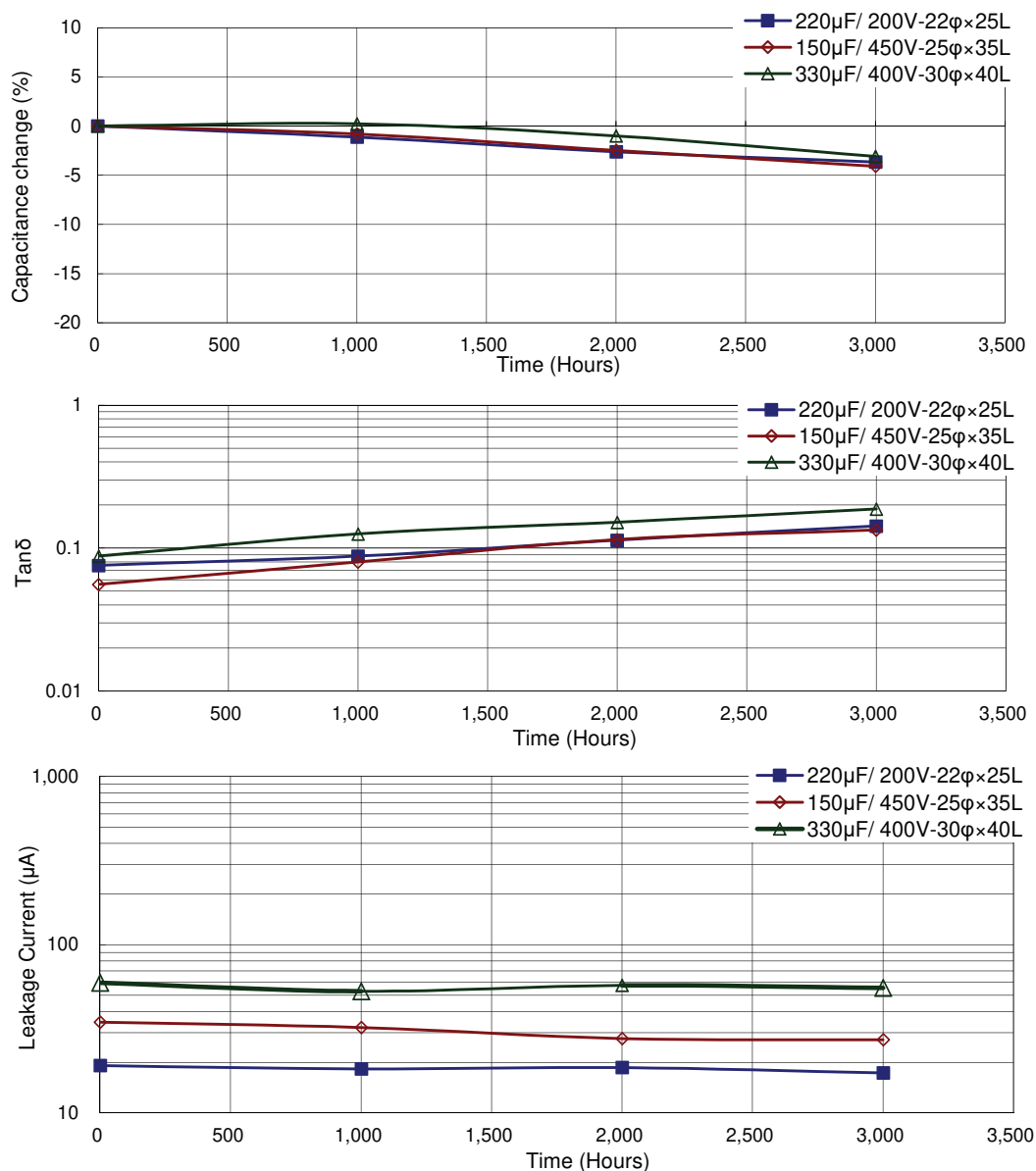

Useful Life Chart

