

Features

- Snap-in terminal type
- 105°C, 3,000 hours assured
- High Ripple current.
- RoHS compliance



Specifications

Items	Performance												
Category Temperature Range	400 ~ 450V												
Capacitance Tolerance	-25°C ~ +105°C ± 20% (at 120 Hz, 20°C)												
Leakage Current (at 20°C)	$I = 3\sqrt{CV}$ or 1.5 mA whichever is smaller (after 5 minutes) Where, C = rated capacitance in μF, V = rated DC Rated Voltage in V												
Tanδ (at 120 Hz, 20°C)	<table border="1"> <thead> <tr> <th>Rated Voltage</th> <th>400</th> <th>450</th> </tr> </thead> <tbody> <tr> <td>Tanδ(max)</td> <td>0.15</td> <td>0.15</td> </tr> </tbody> </table>	Rated Voltage	400	450	Tanδ(max)	0.15	0.15						
Rated Voltage	400	450											
Tanδ(max)	0.15	0.15											
Low Temperature Characteristics (at 120 Hz)	<p>Impedance ratio shall not exceed the values given in the table below.</p> <table border="1"> <thead> <tr> <th>Rated Voltage</th> <th>400</th> <th>450</th> </tr> </thead> <tbody> <tr> <td>Impedance Ratio Z(-25°C)/ Z(+20°C)</td> <td>8</td> <td>8</td> </tr> </tbody> </table>	Rated Voltage	400	450	Impedance Ratio Z(-25°C)/ Z(+20°C)	8	8						
Rated Voltage	400	450											
Impedance Ratio Z(-25°C)/ Z(+20°C)	8	8											
Endurance	<table border="1"> <thead> <tr> <th>Test Time</th> <th>3,000 Hrs</th> </tr> </thead> <tbody> <tr> <td>Capacitance Change</td> <td>Within ±20% of initial value</td> </tr> <tr> <td>Tanδ</td> <td>Less than 200% of specified value</td> </tr> <tr> <td>Leakage Current</td> <td>Within specified value</td> </tr> </tbody> </table> <p>* The above specifications shall be satisfied when the capacitors are restored to 20°C after the rated voltage applied with rated ripple current for 3,000 hours at 105°C.</p>	Test Time	3,000 Hrs	Capacitance Change	Within ±20% of initial value	Tanδ	Less than 200% of specified value	Leakage Current	Within specified value				
Test Time	3,000 Hrs												
Capacitance Change	Within ±20% of initial value												
Tanδ	Less than 200% of specified value												
Leakage Current	Within specified value												
Shelf Life Test	<table border="1"> <thead> <tr> <th>Test Time</th> <th>1,000 Hrs</th> </tr> </thead> <tbody> <tr> <td>Capacitance Change</td> <td>Within ±15% of initial value</td> </tr> <tr> <td>Tanδ</td> <td>Less than 150% of specified value</td> </tr> <tr> <td>Leakage Current</td> <td>Within specified value</td> </tr> </tbody> </table> <p>* The above specifications shall be satisfied when the capacitors are restored to 20°C after exposing them for 1,000 hours at 105°C without voltage applied. The rated voltage shall be applied to the capacitors before the measurements (Refer to JIS C 5101-4 4.1).</p>	Test Time	1,000 Hrs	Capacitance Change	Within ±15% of initial value	Tanδ	Less than 150% of specified value	Leakage Current	Within specified value				
Test Time	1,000 Hrs												
Capacitance Change	Within ±15% of initial value												
Tanδ	Less than 150% of specified value												
Leakage Current	Within specified value												
Ripple Current and Frequency Multipliers	<table border="1"> <thead> <tr> <th>Frequency (Hz)</th> <th>50 / 60</th> <th>100 / 120</th> <th>300</th> <th>1k</th> <th>10k up</th> </tr> </thead> <tbody> <tr> <td>Multiplier</td> <td>0.8</td> <td>1.0</td> <td>1.1</td> <td>1.3</td> <td>1.4</td> </tr> </tbody> </table>	Frequency (Hz)	50 / 60	100 / 120	300	1k	10k up	Multiplier	0.8	1.0	1.1	1.3	1.4
Frequency (Hz)	50 / 60	100 / 120	300	1k	10k up								
Multiplier	0.8	1.0	1.1	1.3	1.4								
Failure percentage Failure rate	When the failure percentage / failure rate is required, please contact with us for further discussion.												

Diagram of Dimensions

Unit: mm

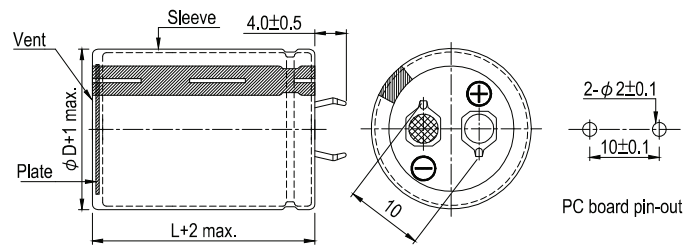

Dimension and Permissible Ripple Current

Rated Voltage V _{dc}	Capacitance 120 Hz, 20°C µF	φ D×L mm	Ripple Current 120 Hz, 105°C A/rms	Tan δ at 120 Hz, 20°C	ESR 120 Hz, 20°C Ω	LC 5 minutes mA	Part Number
400	100	22 × 25	1.02	0.15	1.194	0.60	LSR101M2G--A2225
	120	22 × 30	1.22	0.15	0.995	0.66	LSR121M2G--A2230
	120	25 × 25	1.22	0.15	0.995	0.66	LSR121M2G--A2525
	150	22 × 35	1.33	0.15	0.796	0.73	LSR151M2G--A2235
	180	22 × 40	1.43	0.15	0.664	0.80	LSR181M2G--A2240
	180	25 × 30	1.43	0.15	0.664	0.80	LSR181M2G--A2530
	180	30 × 25	1.68	0.15	0.664	0.80	LSR181M2G--A3025
	220	22 × 45	1.55	0.15	0.543	0.89	LSR221M2G--A2245
	220	25 × 35	1.65	0.15	0.543	0.89	LSR221M2G--A2535
	220	30 × 30	1.79	0.15	0.543	0.89	LSR221M2G--A3030
	270	22 × 50	1.68	0.15	0.442	0.99	LSR271M2G--A2250
	270	25 × 40	1.83	0.15	0.442	0.99	LSR271M2G--A2540
	270	30 × 35	2.12	0.15	0.442	0.99	LSR271M2G--A3035
	270	35 × 25	2.12	0.15	0.442	0.99	LSR271M2G--A3525
	330	25 × 50	2.12	0.15	0.362	1.09	LSR331M2G--A2550
	330	30 × 40	2.33	0.15	0.362	1.09	LSR331M2G--A3040
	330	35 × 30	2.33	0.15	0.362	1.09	LSR331M2G--A3530
	390	30 × 45	2.52	0.15	0.306	1.18	LSR391M2G--A3045
	390	35 × 35	2.52	0.15	0.306	1.18	LSR391M2G--A3535
	470	30 × 50	2.85	0.15	0.254	1.30	LSR471M2G--A3050
470	35 × 40	2.85	0.15	0.254	1.30	LSR471M2G--A3540	
560	35 × 45	3.18	0.15	0.213	1.42	LSR561M2G--A3545	
680	35 × 50	3.21	0.15	0.176	1.50	LSR681M2G--A3550	
450	82	22 × 25	0.96	0.15	1.456	0.58	LSR820M2W--A2225
	100	22 × 30	1.04	0.15	1.194	0.64	LSR101M2W--A2230
	100	25 × 25	1.04	0.15	1.194	0.64	LSR101M2W--A2525
	120	22 × 35	1.15	0.15	0.995	0.70	LSR121M2W--A2235
	120	25 × 30	1.22	0.15	0.995	0.70	LSR121M2W--A2530
	150	22 × 40	1.22	0.15	0.796	0.78	LSR151M2W--A2240
	150	25 × 35	1.31	0.15	0.796	0.78	LSR151M2W--A2535
	150	30 × 25	1.31	0.15	0.796	0.78	LSR151M2W--A3025
	180	22 × 45	1.35	0.15	0.664	0.85	LSR181M2W--A2245
	180	25 × 40	1.35	0.15	0.664	0.85	LSR181M2W--A2540
	180	30 × 30	1.60	0.15	0.664	0.85	LSR181M2W--A3030
	180	35 × 25	1.60	0.15	0.664	0.85	LSR181M2W--A3525
	220	25 × 45	1.55	0.15	0.543	0.94	LSR221M2W--A2545
	220	30 × 35	1.71	0.15	0.543	0.94	LSR221M2W--A3035
	270	25 × 50	1.74	0.15	0.442	1.05	LSR271M2W--A2550
	270	30 × 40	1.90	0.15	0.442	1.05	LSR271M2W--A3040
	270	35 × 30	1.90	0.15	0.442	1.05	LSR271M2W--A3530
	330	30 × 45	2.20	0.15	0.362	1.16	LSR331M2W--A3045
	330	35 × 35	2.20	0.15	0.362	1.16	LSR331M2W--A3535
	390	30 × 50	2.40	0.15	0.306	1.26	LSR391M2W--A3050
390	35 × 40	2.42	0.15	0.306	1.26	LSR391M2W--A3540	
470	35 × 45	2.67	0.15	0.254	1.38	LSR471M2W--A3545	
560	35 × 50	2.85	0.15	0.213	1.50	LSR561M2W--A3550	

Part Numbering System

LSR Series 220µF ±20% 400V 4.0±0.5mm 30 φ × 30L

LSR **221**
Series Name Capacitance

Example:

Cap.	Symbol
56	560
220	221
470	471

M **2G**
Capacitance tolerance Rated voltage

Example:

Voltage	Symbol
400	2G
450	2W

M = ±20%
K = ±10%

-- **A**
Terminal type Terminal length

Example:

Type	Symbol
2 pins	--
5 pins	L5

": 6.3±1.0 mm

3030
Case size

Example:

φ D×L	Code
22×30	2230
25×25	2525
30×40	3040

XX
S = Standard
KS = AEC-Q200 Qualified, Safety Critical Application
LS = AEC-Q200 Qualified, Non-Safety Critical Application

Typical Endurance Curves

