

STDS-08

FEATURES

※3-state setting

APPLICATION

- ※Remote control
- ※Home automation
- ※Telecommunication

SPECIFICATION

Contact Rating	25mA, 24V DC
Contact Resistance	100mΩ max.
Insulation Resistance	100MΩ min. 500V DC
Dielectric Strength	500V AC/1 minute
Operating Force	1,000gf max.
Travel	1mm
Operating Life	2,000 cycles
Operating Temp.	-20°C ~ +70°C
Storage Temp.	-40°C ~ +85°C

CIRCUIT

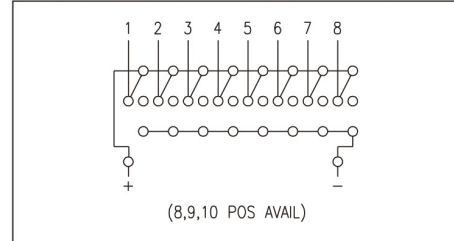

PACKAGE

<Tube>

- STDS-08: 19 pcs
- STDS-09: 17 pcs
- STDS-10: 16 pcs

HOW TO ORDER

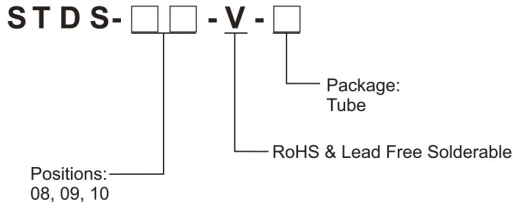

DIP SWITCH

STDS

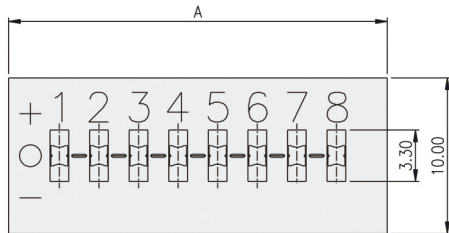

PART NO.	NO. OF POS.	DIM.A	DIM.B
STDS-08	8	24.30	17.78
STDS-09	9	26.84	20.32
STDS-10	10	29.38	22.86

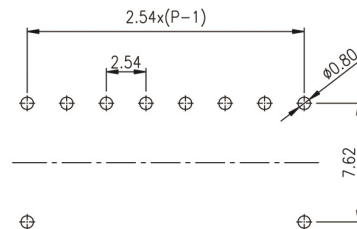
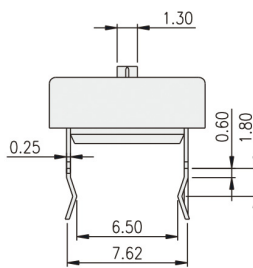
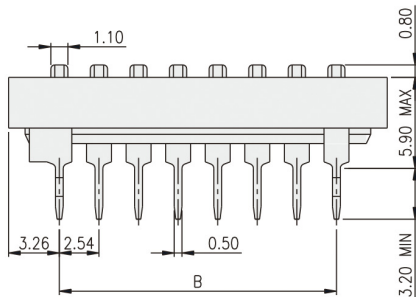

P.C.B. LAYOUT